

### Features & Benefits

#### Ergonomic

- An integral finger support and lightweight design reduces physical strain, making repetitive jobs less of a chore.

#### Accurate

- Be confident in accuracy; each pipettor is supplied with a performance certificate, according to ISO8655/DIN12650.

#### Volume Setting

- Is clearly displayed on the side of the unit .

#### Ejector Key

- Conveniently located, allowing one handed operation.

#### Range

- Huge range from 0.5 $\mu$ L to 5mL.

#### Calibration & Maintenance

- Is easy with the supplied calibration tool.

#### Autoclavable\*

- Fully Autoclavable!

#### Rotating Head#

- For maximum comfort and convenience in dispensing.

#### Cone#

- Individual cone/piston assemblies making repair and maintenance easy.

\* 121 °C for 20 minutes.

\* After autoclaving the pipette should be left to cool down and dry for 12 hours.

\* It is recommend that the performance of the pipettor is checked after each autoclave.

# 8 Channel and 12 Channel models only.



# Liquid Handling

## Pipettor - Operation

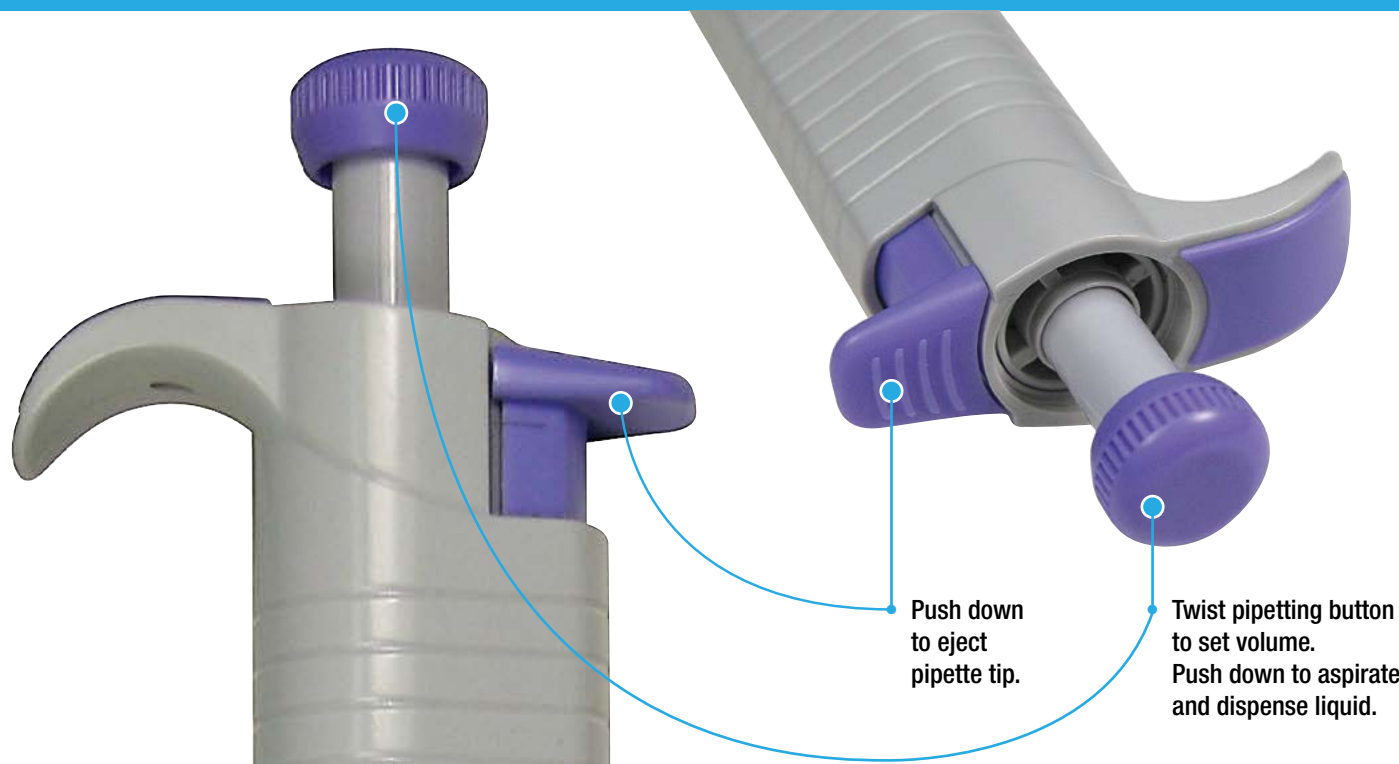

Push down to eject pipette tip.

Twist pipetting button to set volume. Push down to aspirate and dispense liquid.



Calibration tool supplied.



Current volume setting.



Keep your laboratory tidy with the supplied bench mount.







### Single Channel Pipettor - Technical Specifications:

Volume Range	Graduation	Volume Tested	Maximum Permissible Systematic Error (Inaccuracy)		Maximum Permissible Random Error (Imprecision)	
			%	$\mu\text{l}$	%	$\mu\text{l}$
0.5 to 10 $\mu\text{l}$	0.1 $\mu\text{l}$	10 $\mu\text{l}$	1.00%	0.1	0.80%	0.8
		5 $\mu\text{l}$	1.50%	0.075	1.50%	0.075
		1 $\mu\text{l}$	2.50%	0.025	1.50%	0.015
2 to 20 $\mu\text{l}$	0.5 $\mu\text{l}$	20 $\mu\text{l}$	0.90%	0.18	0.40%	0.08
		10 $\mu\text{l}$	1.20%	0.12	1.00%	0.1
		2 $\mu\text{l}$	3.00%	0.06	2.00%	0.04
10 to 100 $\mu\text{l}$	1 $\mu\text{l}$	100 $\mu\text{l}$	0.80%	0.8	0.15%	0.15
		50 $\mu\text{l}$	1.00%	0.5	0.40%	0.2
		10 $\mu\text{l}$	3.00%	0.3	1.50%	0.15
20 to 200 $\mu\text{l}$	1 $\mu\text{l}$	200 $\mu\text{l}$	0.60%	1.2	0.15%	0.3
		100 $\mu\text{l}$	0.80%	0.8	0.30%	0.3
		20 $\mu\text{l}$	3.00%	0.6	1.00%	0.2
100 to 1000 $\mu\text{l}$	5 $\mu\text{l}$	1000 $\mu\text{l}$	0.60%	6	0.20%	2
		500 $\mu\text{l}$	0.70%	3.5	0.25%	1.25
		100 $\mu\text{l}$	2.00%	2	0.70%	0.7
1000 to 5000 $\mu\text{l}$	50 $\mu\text{l}$	5000 $\mu\text{l}$	0.50%	25	0.15%	7.5
		2500 $\mu\text{l}$	0.60%	15	0.30%	7.5
		1000 $\mu\text{l}$	0.70%	7	0.30%	3

### Ordering Information:

Supplied with: pipettor, quality control certificate, bench mount, calibration tool, silicone grease, user manual.

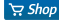
Product Code	Description	Pack Size
 550.002.005	0.5 to 10 $\mu\text{L}$	Each
 550.002.007	2.0 to 20 $\mu\text{L}$	Each
 550.002.009	10 to 100 $\mu\text{L}$	Each
 550.002.011	20 to 200 $\mu\text{L}$	Each
 550.002.013	100 to 1000 $\mu\text{L}$	Each
 550.002.015	1 to 5mL	Each



# Liquid Handling

## Pipettor - 8 Channel

### 8 Channel Pipettor - Technical Specifications:

Volume Range	Graduation	Volume Tested	Maximum Permissible Systematic Error (Inaccuracy)		Maximum Permissible Random Error (Imprecision)	
			%	$\mu\text{l}$	%	$\mu\text{l}$
0.5 to 10 $\mu\text{l}$	0.1 $\mu\text{l}$	10 $\mu\text{l}$	1.50%	0.15	1.50%	0.15
		5 $\mu\text{l}$	2.50%	0.125	2.50%	0.125
		1 $\mu\text{l}$	4.00%	0.04	4.00%	0.04
5 to 50 $\mu\text{l}$	0.5 $\mu\text{l}$	50 $\mu\text{l}$	1.00%	0.5	0.50%	0.25
		25 $\mu\text{l}$	1.50%	0.375	1.00%	0.25
		5 $\mu\text{l}$	3.00%	0.15	2.00%	0.1
50 to 300 $\mu\text{l}$	5 $\mu\text{l}$	300 $\mu\text{l}$	0.70%	2.1	0.25%	0.75
		150 $\mu\text{l}$	1.00%	1.5	0.50%	0.75
		50 $\mu\text{l}$	1.50%	0.75	0.80%	0.4

### Ordering Information:

Supplied with: pipettor, quality control certificate, bench mount, calibration tool, silicone grease, user manual.

Product Code	Description	Pack Size
550.002.020	0.5 to 10 $\mu\text{L}$	Each
550.002.022	5 to 50 $\mu\text{L}$	Each
550.002.024	50 to 300 $\mu\text{L}$	Each

Shop

Shop

Shop





### 12 Channel Pipettor - Technical Specifications:

Volume Range	Graduation	Volume Tested	Maximum Permissible Systematic Error (Inaccuracy)		Maximum Permissible Random Error (Imprecision)	
			%	$\mu$ l	%	$\mu$ l
0.5 to 10 $\mu$ l	0.1 $\mu$ l	10 $\mu$ l	1.50%	0.15	1.50%	0.15
		5 $\mu$ l	2.50%	0.125	2.50%	0.125
		1 $\mu$ l	4.00%	0.04	4.00%	0.04
5 to 50 $\mu$ l	0.5 $\mu$ l	50 $\mu$ l	1.00%	0.5	0.50%	0.25
		25 $\mu$ l	1.50%	0.375	1.00%	0.25
		5 $\mu$ l	3.00%	0.15	2.00%	0.1
50 to 300 $\mu$ l	5 $\mu$ l	300 $\mu$ l	0.70%	2.1	0.25%	0.75
		150 $\mu$ l	1.00%	1.5	0.50%	0.75
		50 $\mu$ l	1.50%	0.75	0.80%	0.4

### Ordering Information:

Supplied with: pipettor, quality control certificate, bench mount, calibration tool, silicone grease, user manual.

Product Code	Description	Pack Size
 550.002.030	0.5 to 10 $\mu$ L	Each
 550.002.032	5 to 50 $\mu$ L	Each
 550.002.034	50 to 300 $\mu$ L	Each

